

Swivel Socket Assembly Instructions

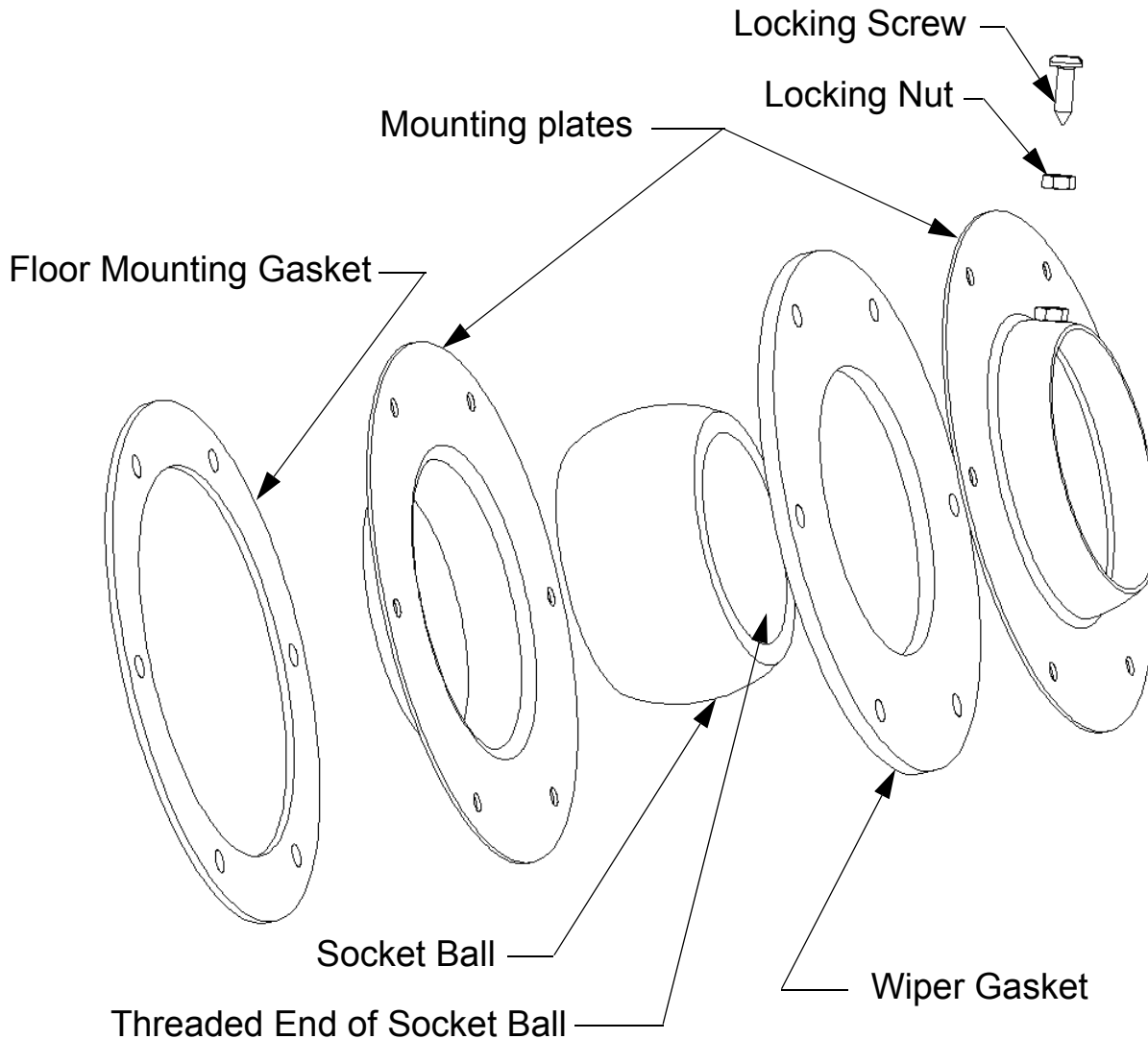

-
- Assemble swivel socket as shown above then bolt to vessel.
 - Assemble SmartSonic by screwing into the threaded end of the swivel ball.
 - Adjust desired angle.
 - Tighten screw (do not over tighten) and secure screw with lock nut.
-

Distribué par :



2 rue René Laennec 51500 Taissy France
Fax: 03 26 85 19 08, Tel : 03 26 82 49 29

Email : hvssystem@hvssystem.com
Site web : www.hvssystem.com